

REPLACEMENT PARTS SUITABLE FOR KOMATSU®

G990™, G9120™ TORCH, 90A
RASOR® KCR-1251, 12714, 9714, 0951

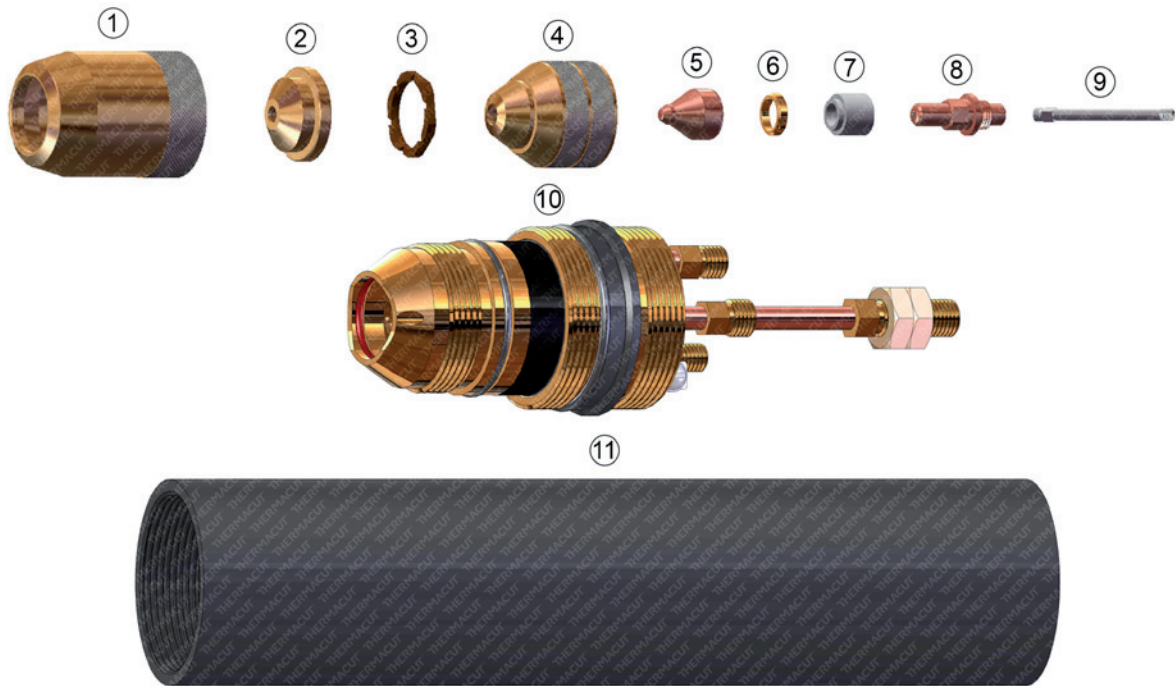

Item	Part No.	Ref. No.	Description	Std. Pkg	Item	Part No.	Ref. No.	Description	Std. Pkg.
1.	T-2057	65-0434-016	Cap #2	1	7.	T-2061	65-0434-020	Guide	1
2.	T-4097	65-0442-005	Shield Cap	1	8.	T-2321	65-0442-001	Electrode	5
3.	T-2359	65-0442-004	Spacer Ring	1	9.	T-3421	65-0442-009	Cooling Tube, 120A	1
4.	T-2056	65-0434-015	Cap #1	1	10.	T-8818	7848-65-5620	Torch Body	1
5.	T-2054	65-0434-007	Nozzle, 1.1mm	5	11.	T-11198	969-94-61310	Tube	1
	T-2353	65-0442-002	Nozzle, 1.3mm	5	NS	KT-1414	K.G990.10M.K	G990™ Cable Leads 10m (33')	1
6.	T-9595	65-0434-018	Swirl Ring	2					

NS NOT SHOWN IN THE PICTURE

Last update of this page: 07/09/2017. See Revision history for details.

THERMACUT®
THE CUTTING COMPANY

WWW.THERMACUT.CZ
TEL.: +420 556 423 418
SALES@THERMACUT.CZ

WWW.THERMACUT.DE
TEL.: +49 (0) 27 39 40 33 0
INFO@THERMACUT.DE

WWW.THERMACUT.COM
TEL.: 1-603-542-6715
CUSTOMERSERVICE@THERMACUT.COM

THERMACUT®, FHT-EX® AND EX-TRAFIRE® ARE REGISTERED TRADEMARKS OF THERMACUT, K.S. AND MAY BE REGISTERED IN CZECH REPUBLIC AND/OR OTHER COUNTRIES. ALL OTHER TRADEMARKS ARE PROPERTIES OF THEIR RESPECTIVE OWNERS. THERMACUT IS NO WAY AFFILIATED WITH KOMATSU®. MOST THERMACUT PARTS ARE MADE FOR OR BY AN IBG COMPANY. PARTS INDICATED WITH A OEM ARE ORIGINAL PARTS MANUFACTURED BY THE ABOVE NAMED MANUFACTURER AND ARE BEING RESOLD BY THERMACUT. THERMACUT RESERVES THE RIGHT TO SUBSTITUTE OEM PARTS IN PLACE OF THERMACUT PARTS. VALID FROM FEBRUARY 2018 • PREVIOUS VERSION IS NO LONGER VALID. • © COPYRIGHT 2018 BY THERMACUT® CZECH REPUBLIC. ALL RIGHTS RESERVED.